



Surface Sanitising System

Instruction Manual

CAUTION

Read instructions before using the Mist Pro 360

This machine is not suitable for spraying / sanitising electrical items.

KEEP FOR FUTURE REFERENCE

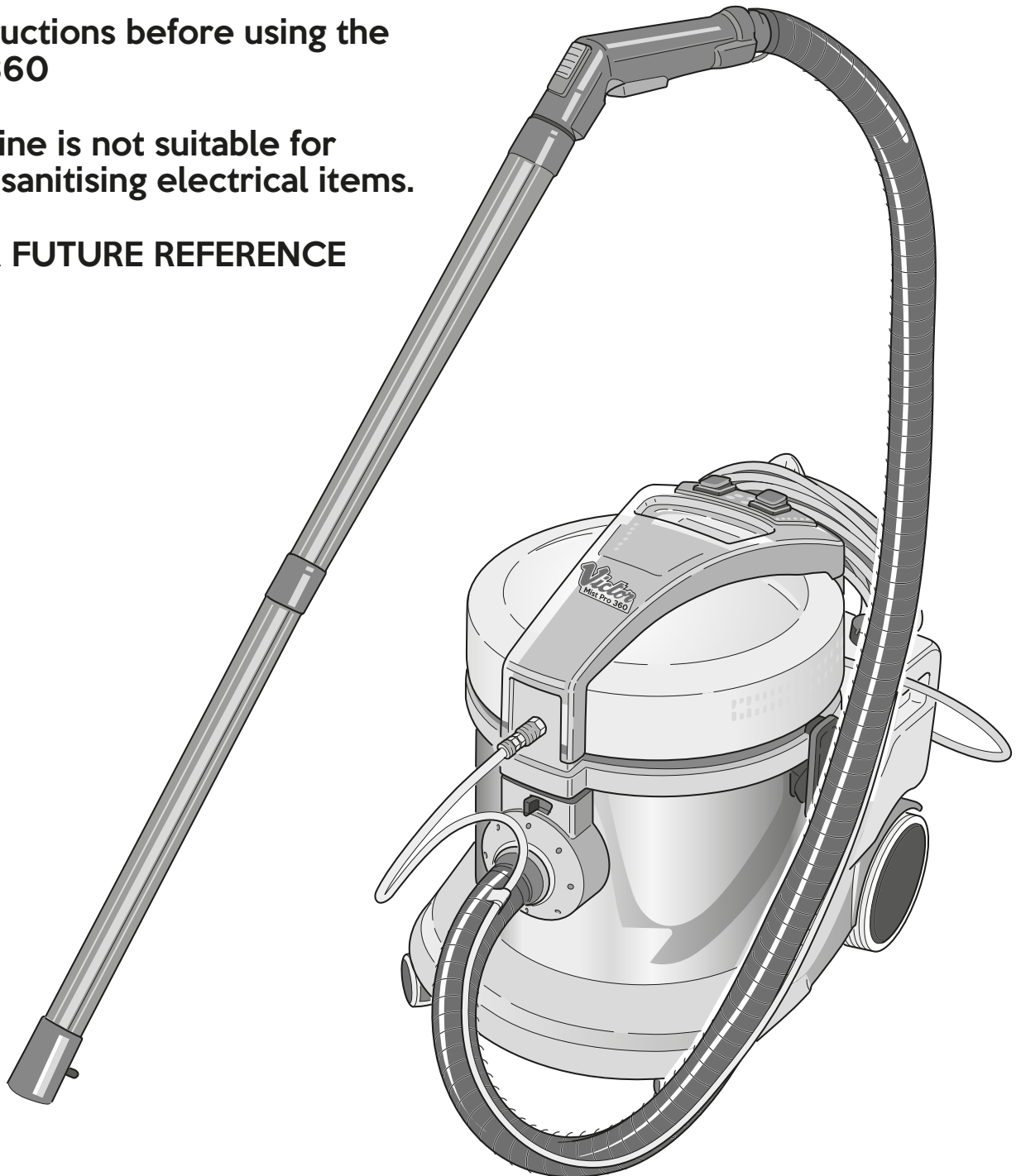

Contents - Mist Pro 360 Unit, Hose, Nozzle, Extension Lance.



DANGER:

This manual forms an integral part of the machine itself. It must therefore be kept in a safe place where it is accessible to all users (operators and maintenance personnel) throughout the life of the machine.

TYPE OF USE

This appliance was designed for mist disinfecting and sanitising. It has only been designed for these uses.

DANGER:

The manufacturer can not be held responsible for any damage due to improper or incorrect use. Any other use releases the manufacturer from liability for harm to persons and/or property and invalidates any warranty condition.

IMPROPER USE

Do not use the appliance to: Mist flammable, explosive, corrosive and toxic substances. Expel hot substances. Do not use the appliance in areas at risk of explosion. Do not use the appliance to sanitise electrical equipment.

NOTE: This Appliance is not suitable for misting electrical devices or equipment.

Important: Always disconnect the machine from power socket after use.

TECHNICAL CHARACTERISTICS

Voltage	220 - 240 v 50/60 Hz
Dimensions	530 x 380 x 485H mm
Weight.....	11 kg
Tank Capacity.....	7 ltr
Flow	140ml per min
Coverage	12m2 Per Min
Spray Distance	3m
Droplet Size	15 - 30 Microns
Run Time Capacity	50 Minutes (per 7L)
Hose Length	2.5 m
Cable Length	7 m
Pressure	3.2 BAR

Assembly - Connecting the solution tube to the unit

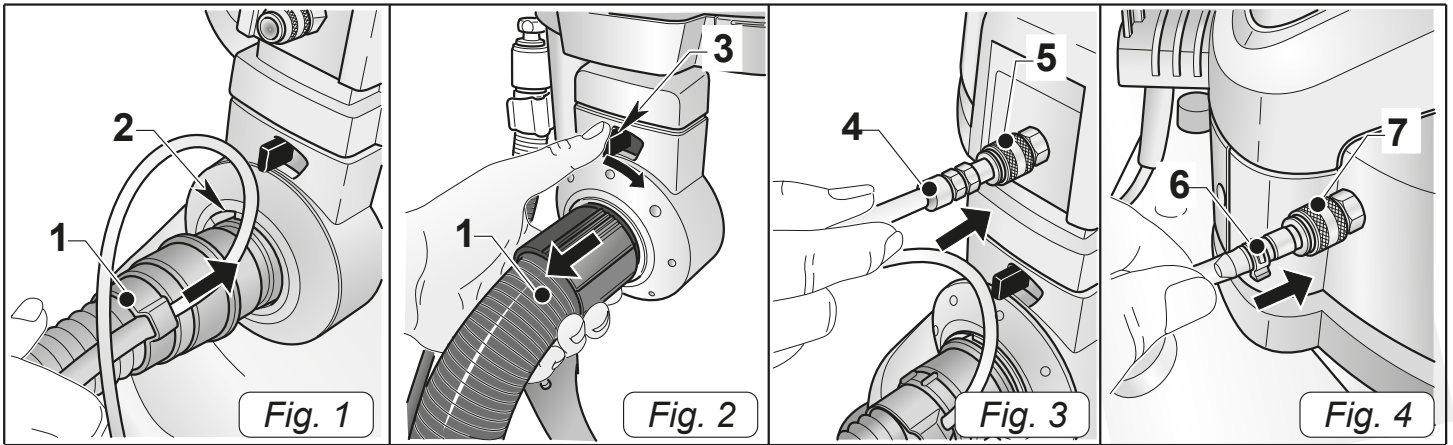

Assembling the hoses

- Insert, as far as possible, the sleeve (1 Fig. 1) of the air hose into the nozzle (2 Fig. 1) on the drum.
- To release the sleeve (1 Fig. 2) move the lever (3 Fig. 2) clockwise then pull the sleeve outwards (1 Fig. 2).
- Connect the (4 Fig. 3) sanitising solution delivery hose to the quick coupling (5 Fig. 3); to release it push the quick coupling (5 Fig. 3) inwards.
- Connect the sanitising solution suction (6 Fig. 4) hose to the quick coupling (7 Fig. 4); to release it push the quick coupling (7 Fig. 4) inwards.

Assembly - Connecting the extension nozzle pipe

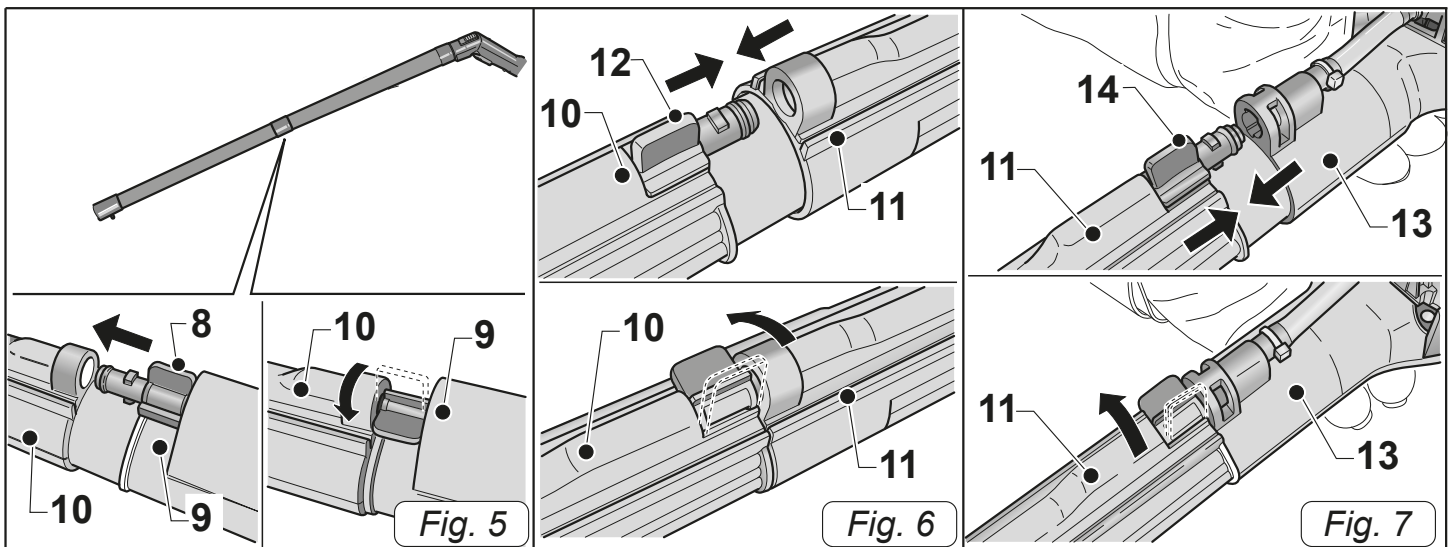

Rigid pipe assembly for long range misting (if present)

After connecting the air hose to the outlet the drum, do as follows:

- Make sure the lever (8 Fig. 5) is in vertical position then attach the first extension (10 Fig. 5) to the ergonomic handle (9 Fig. 5) of the flexible hose and lock it in place by turning the lever (8 Fig. 5) to the horizontal position.
- Attach the first extension (10 Fig. 6) to the second extension (11 Fig. 6) and lock it in place using the lever (12 Fig. 6) as described previously for the first extension.
- Attach the misting nozzle (13 Fig. 7) to the second extension (11 Fig. 7) and lock it in place using the lever (14 Fig. 7) as described above

Filling the Tank

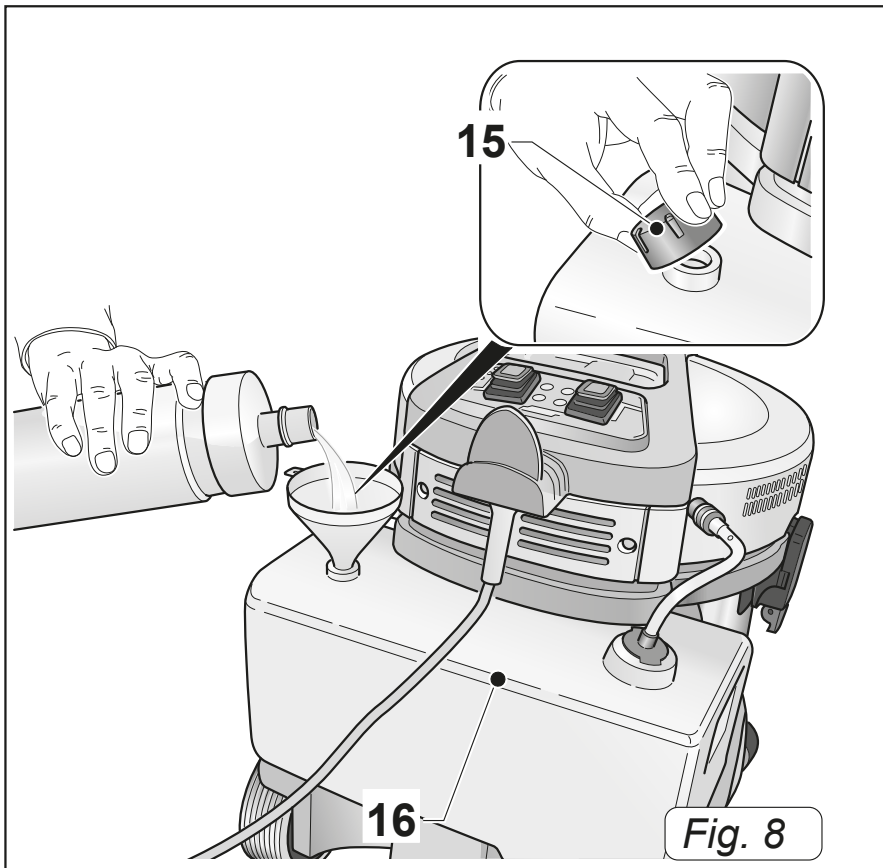

Filling the sanitising solution tank

- Remove the cap (15 Fig. 8) and pour the sanitising solution (suitable for misting purposes only) into the tank (16 Fig. 8).

NOTE:

For sanitising solution dosing refer to the manufacturer's instructions.

- Put the cap back on (15 Fig. 8)

- Do not fill beyond Max Fill Level.

NOTE:

The Mist Pro 360 has been specifically designed to be used with V-SMS5 Sanitiser Mist Solution. Incorrect selection of other liquids or solutions with this device may cause damage and invalidate the warranty. Damage may include, but is not limited to, corrosion, pump failure, unsatisfactory mist performance, lack of sanitised areas.

- V-SMS5 Sanitiser Mist Solution is a ready to use solution where dilution is not required.



Victor

Hygiene Range

For best results and
To avoid risk of
invalidating warranty,
recommended for
use with Victor
Sanitiser Mist
Solution

Refills available from www.VictorFloorcare.com

* 99.9999% effective in inactivating and destroying pathogens when using complete Mist Pro 360 System. System comprises Mist pro 360 unit applying V-SMS5 Victor Sanitiser Mist Solution. V-SMS5 Victor Sanitiser Mist Solution Meets the requirements of: EN1276, EN1650, EN13697 and EN14476.

Key Features - Mist Pro 360

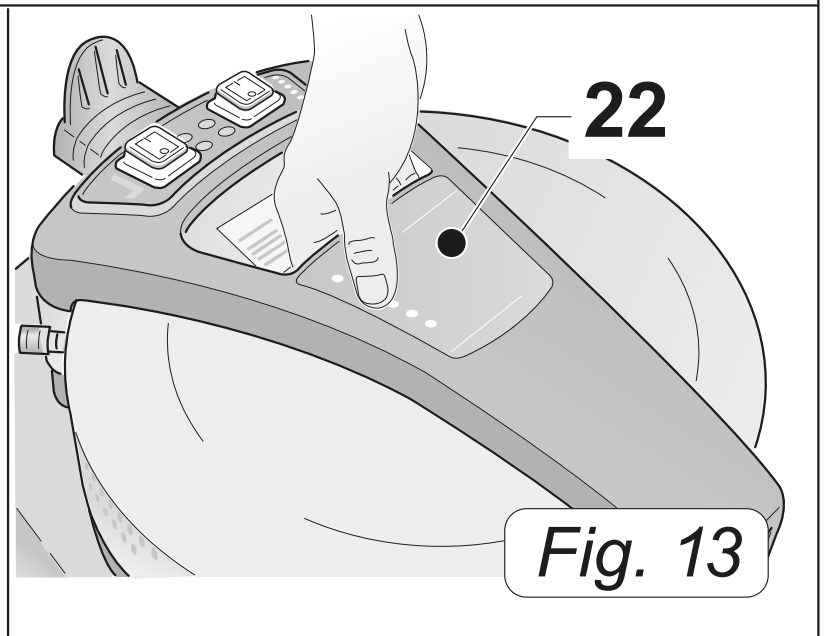
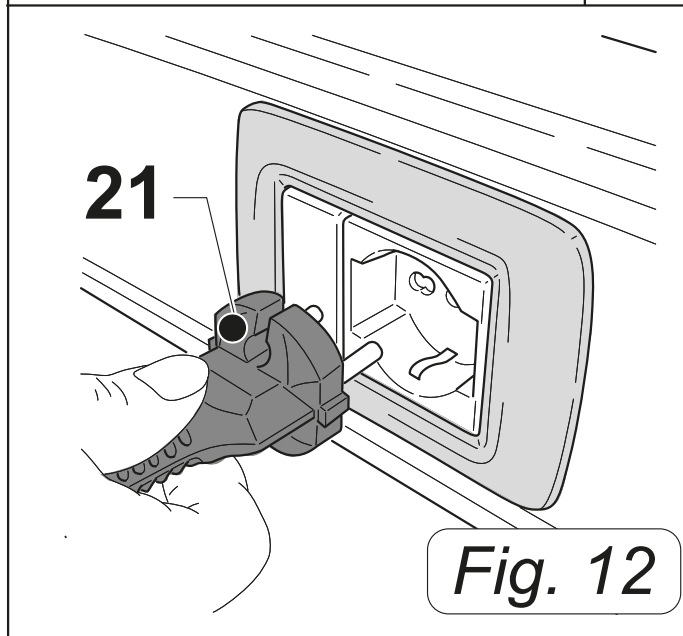
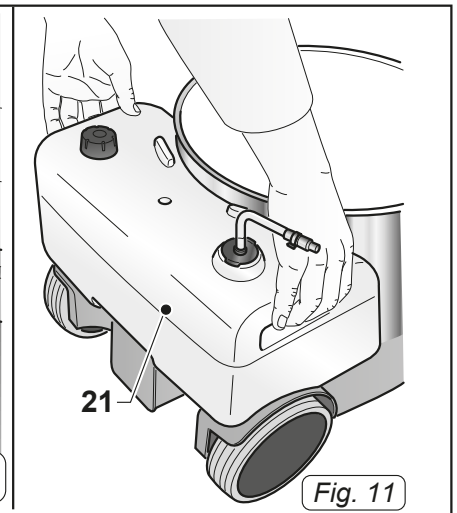
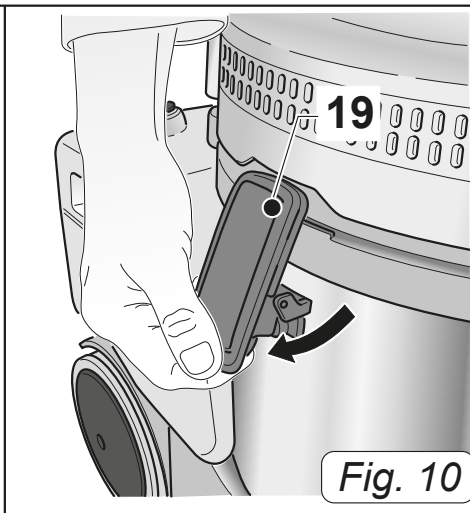
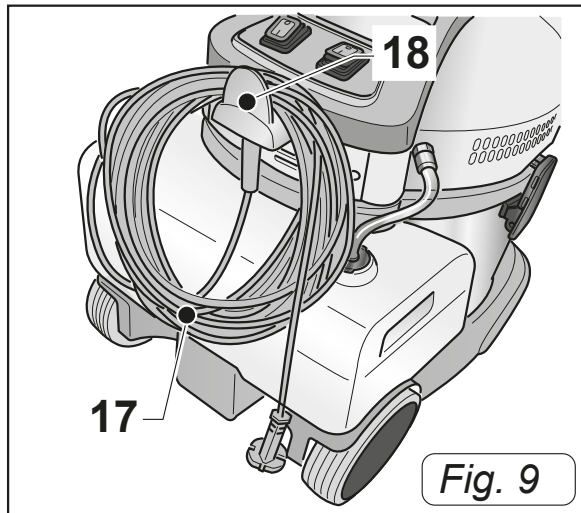

Storing Cables

- When not in use, wrap power cable around the hooks provided (17-18 Fig 9)

Motor Housing

- To remove the motor housing from the base, release 2 clips (19 Fig 10)

Removing Fluid Tank

- To remove the fluid tank for maintenance purposes, disconnect the fluid line and lift from the base. (20 Fig 11)

Country Specific Power supply

- As standard, your Mist Pro 360 device has been fitted with a UK power cable.

On request this can be changed to a country specific power cable prior to purchase. (21 Fig 12)

Carry Handle

- The appliance is fitted with wheels and can therefore be pulled along using the flexible hose.

- To lift it up, insert your fingers under the handle (22 Fig. 13) on the top of the cover.

Operation Guide - Mist Pro 360

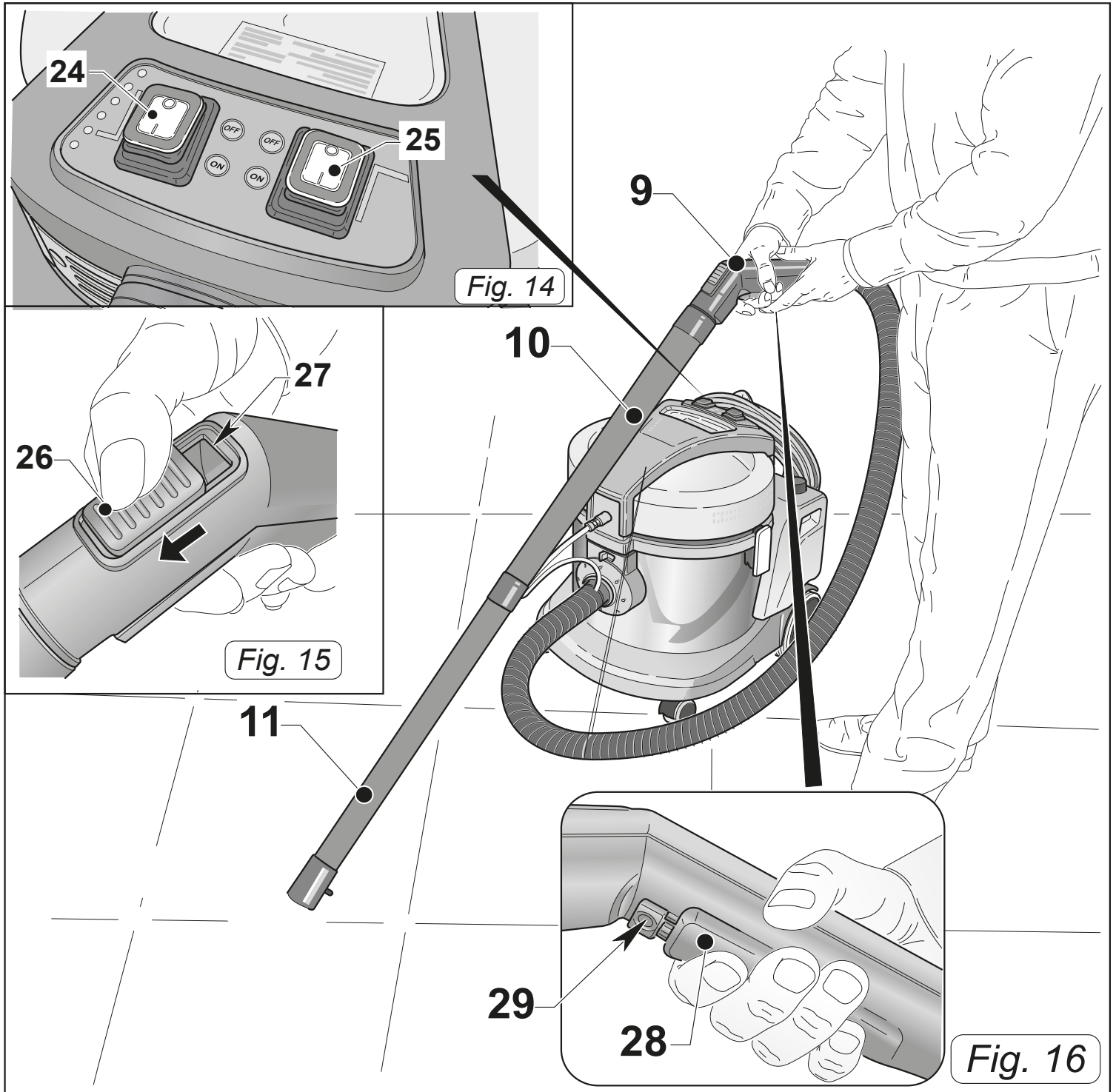

USING THE APPLIANCE

Starting up the appliance

- Insert the plug (21 Fig. 12) into the electrical socket.
- Push the switch (24 Fig. 14) on "I" to start the expulsion motor; the switch lights up.
- Push the switch (25 Fig. 14) on "I" to start the sanitising solution pump; the switch lights up.

NOTE:

The expulsion motor and the sanitising solution pump operate independently; therefore, it is necessary to start both simultaneously.

Creating Mist Flow

- Ensure both pump and motor switches are on "I".
- Press trigger to allow mist to expel from the nozzle (28 Fig 16)

NOTE:

If nozzle releases a jet opposed to a fine mist, ensure motor switch has been pushed to "I"

If Nozzle releases compressed air opposed to fine mist, ensure solution pump switch has been pushed to "I".

Important Information - READ BEFORE USE

This instruction manual forms an integral part of the Mist Pro 360 and must be read before use.

All operators of the Mist Pro 360 device should be suitably instructed before use.

Before use, routine observations and maintenance should be executed to ensure safe operation. - Failure to carry out periodical maintenance could cause the equipment to become unsafe. The manufacturer can accept no responsibility in this event.

Maintenance and the replacement of parts should only be carried out by a fully qualified technician.

Please ensure the machine is fully switched off and disconnected from any power source during routine maintenance, replacing parts or cleaning of the machine.

Any fluid expelled from the machine may be unsafe due to a number of factors, including, but not limited to temperature, pressure or chemical content.

This machine is only intended for applying mist to inanimate objects. Avoid contact with face, eyes and skin.

Appropriate PPE should be worn whilst operating this machine.

The Mist Pro 360 is designed for professional use only and should be kept away from children or untrained persons or those with limited experience at all times.

When operating any electrical equipment, suitable care and attention should be given whilst in use.

This machine has been designed for, and is intended for use in commercial environments only.



CAUTION

The Mist Pro 360 is intended for indoor use only.

The Mist Pro 360 should be stored indoors and never exposed to extreme temperatures for prolonged periods of time.



WARNING

- Do not remove plug from wall socket by pulling power cable.
- Do not immerse.
- The use of pressure washers or steam cleaners to clean this machine is prohibited.
- Intended for indoor use only
- Do not use this machine in the rain.
- Ensure power supply is disconnected from power before commencing any maintenance or cleaning of the machine.
- The power lead should be unwound from the storage hook fully before use.
- Ensure filters are kept clean.
- Ensure machine is kept clean. This includes Nozzles and Hoses.
- Ensure the machine is inspected for damage before and after use. If visible damage occurs, it should be repaired by a qualified person.
- Ensure the power cable is inspected for damage before and after using this machine. If visible damage occurs, it should be replaced by a qualified person.
- Only use Victor approved parts, hoses and nozzles.
- Ensure the fluid tank is empty before inspecting underneath the machine.
- Ensure the Mist Pro 360 motor housing is connected to the drum by both clips on the side before moving. Use handle provided for moving the machine.
- Only use the hose to move the Mist Pro 360 whilst on smooth, even surfaces.
- Consider the weight if the machine before lifting.

Troubleshooting guide

Problem	Cause	Solution
No power to the unit	Switch not pressed. Plug not inserted. Power cut.	Press the switch. Insert the plug into the socket. Check the power Cable connection.
Mist is not satisfactory.	Nozzle or fluid line clogged. Pump or motor not switched on.	Check and clean the flexible hose and the misting nozzle. Check both switches are on.
Not dispensing solution	Nozzle clogged. Pump or motor not switched on.	Clean nozzle. Clean misting filter Check both switches are on.
No mist / only air being released	Switch not pressed.	Press the switch.

Important Information - WEEE Compliance

WEEE Registered Producer: WEE/MM8824AA

The European Community WEEE directive deals with the disposal of Waste Electrical and Electronic Equipment at the end of its useful life.

Our obligation is to ensure the correct disposal of Electrical and Electronic Equipment (EEE) we produce when it reaches the end of its useful life and becomes Waste Electrical and Electronic Equipment (WEEE).

The WEEE symbol on the product indicates that the product must not be disposed of with normal household waste. Instead such marked waste equipment must be disposed of by arranging to return to a designated collection point for the recycling of waste electrical and electronic equipment. Separating and recycling this waste equipment at time of disposal will help to conserve natural resources and ensure that the equipment is recycled in a manner that protects human health and the environment. Victor offers our customers the opportunity to return products at the end of their functional lives to Victor for recycling, qualifying products are marked with the WEEE symbol shown.

Delivery cost of any authorised product returned to Victor will be at the expense of the sender.

Only applies to EU countries

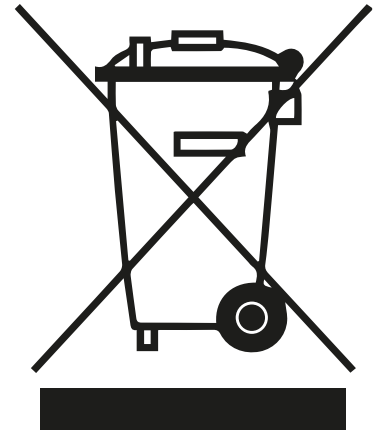

Personal Protective Equipment (PPE)

Following a full risk assessment, Personal Protective Equipment (PPE) may be required for certain applications.



Wet Floor Sign



Ear Protection



Hi-Vis Vest / Jacket



Eye Protection



Protective Headwear



Face Mask



Protective Clothing



Safety Gloves



Safety Footwear

a full risk assessment should be carried out prior to the use of this machine to determine correct use of PPE

Rating Label

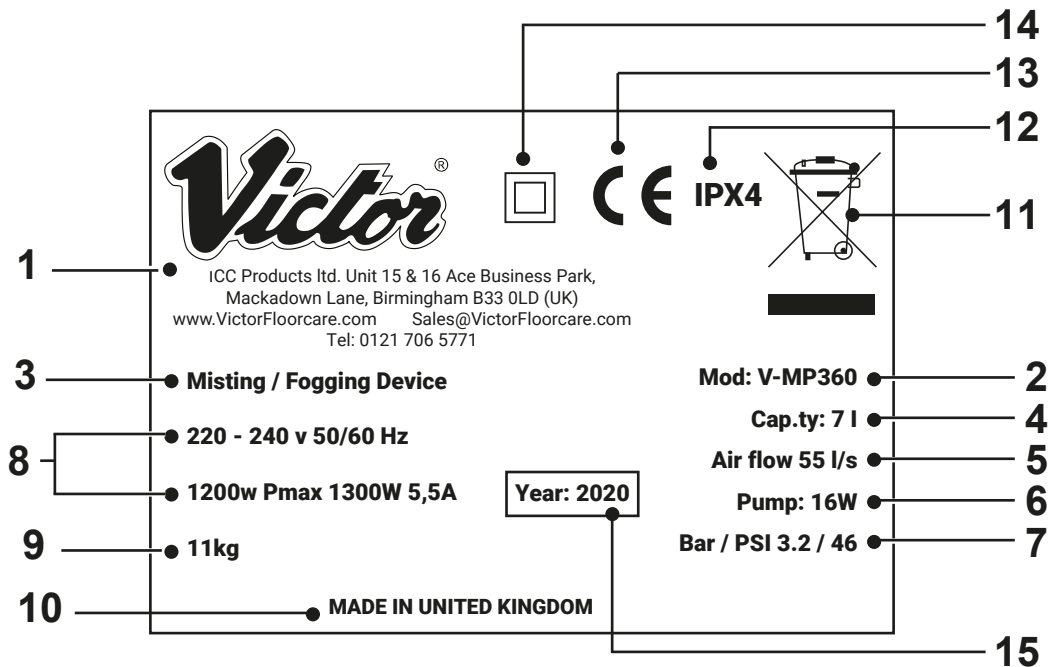
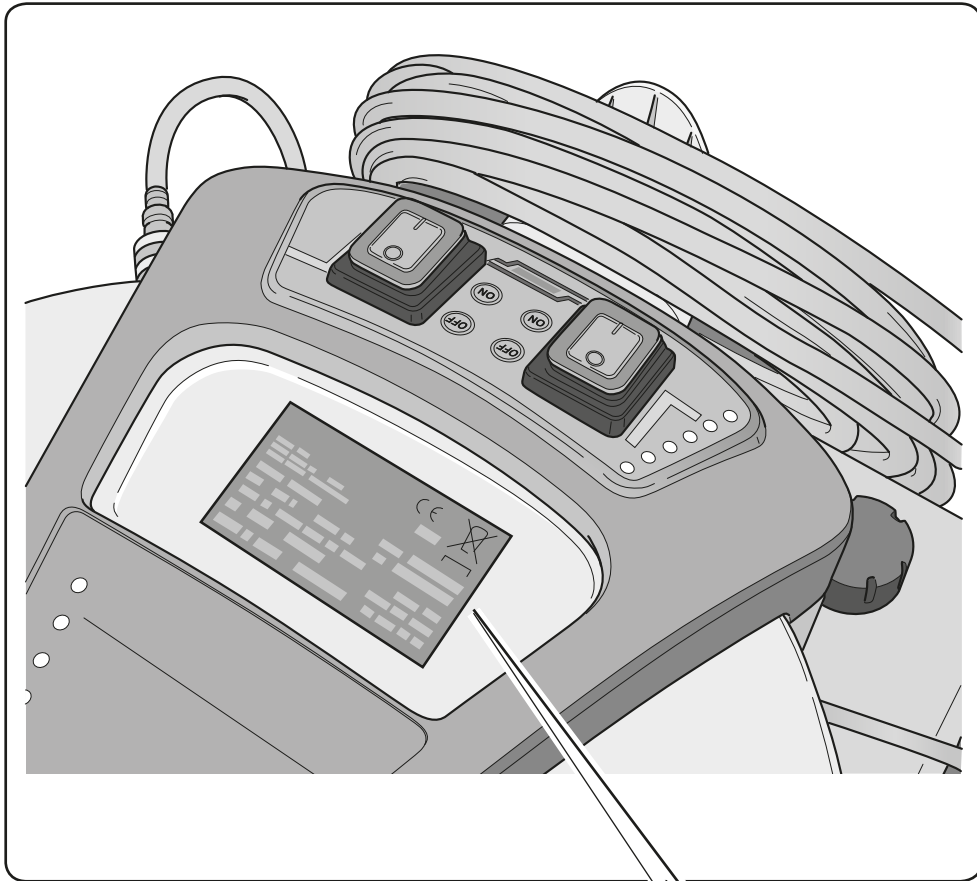

	1	2	3	4
EN	Manufacturer	Model	Product Name	Capacity

	5	6	7	8
EN	Air Flow	Pump	Max Pressure	Electrical Characteristics

	9	10	11	12
EN	Weight	Country of Origin	WEEE Logo	IP Code

	13	14	15
EN	CE Code	Protection Class 2 Symbol	Year

Schematic Datagram - Mist Pro 360

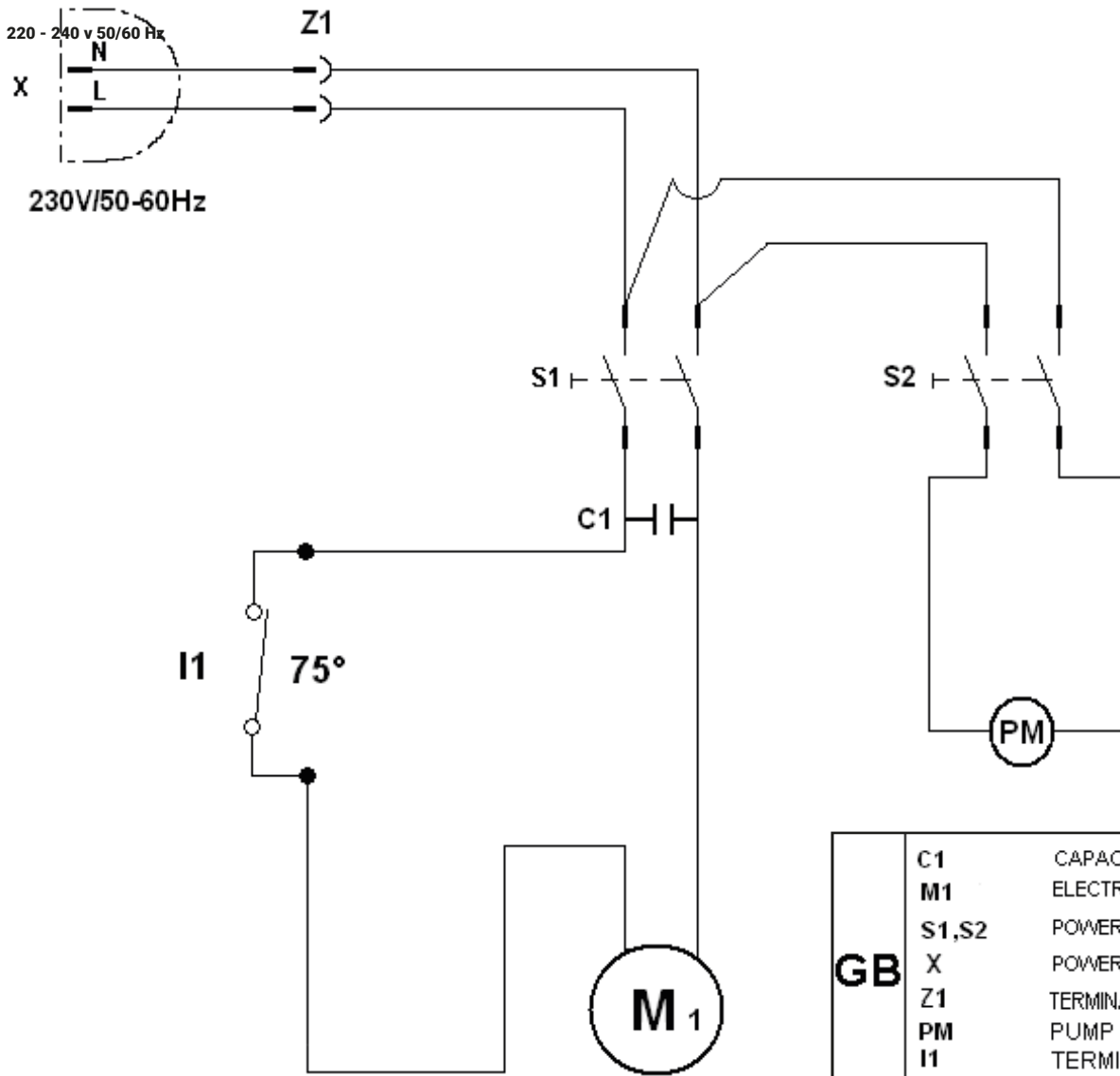

GB	C1	CAPACITOR 0.22 μ F
	M1	ELECTRIC MOTOR
	S1,S2	POWER SWITCH
	X	POWER PLUG
	Z1	TERMINAL BLOCK
	PM	PUMP
	I1	TERMINAL SWITCH 75°
TENSIONE VOLTAGE		230V
FREQUENZA FREQUENCY		50-60Hz
DATA DATE		01/12/2020
SCHEMA ELETTRICO ELECTRIC SCHEME		
MODELLO MODEL		

Technical Spec. - Mist Pro 360

Model	Voltage	Tank Capacity	Coverage	Spray Distance	Droplet Size	Protection Class
Mist Pro 360	220 - 240 v 50/60 Hz	7 LTR	12m ² per min	3m	15 - 30 Microns	Class II

Run Time Capacity	Size	Hose Length	Cable Length	Weight	Pressure Rating	IP Rating
50 min (per 7L)	500 x 380 x 485	2.5m	7m	11kg	3.2 BAR	IPX4





Contact Information

Victor Floorcare
Unit 15 & 16
Ace Business Park
Mackadown Lane
Birmingham
B33 0LD

0121 706 5771

sales@victorfloorcare.com